

CONSTRUCTION TRAFFIC CONTROL GENERAL NOTES

1. PROJECT IS SUBJECT TO THE REQUIREMENTS OF COUNTY ORDINANCE NO. 82.6 AND COUNTY ORDINANCE NO. 66-116. THE CONTRACTOR IS RESPONSIBLE FOR ACQUIRING ALL PERMITS NECESSARY. CONTRACTOR SHALL CALL 848-1504 FOR MORE INFORMATION.
2. THE CONTRACTOR SHALL SUBMIT A TRAFFIC CONTROL PLAN TO BERNALILLO COUNTY TRAFFIC ENGINEERING AT LEAST 3 BUSINESS DAYS PRIOR TO COMMENCEMENT OF WORK. TRAFFIC CONTROL PLANS SHALL BE PREPARED IN ACCORDANCE WITH THE MANUAL ON UNIFORM TRAFFIC CONTROL DEVICES (MUTCD), LATEST EDITION AND BY CERTIFIED PERSONNEL AND MUST BE APPROVED PRIOR TO COMMENCEMENT OF WORK ON THE PROJECT. CALL 848-1504 FOR FURTHER INFORMATION.
3. A DAILY TRAFFIC CONTROL DIARY SHALL BE MAINTAINED BY THE CONTRACTOR REFLECTING THE TYPES AND LOCATIONS OF ALL TRAFFIC CONTROL DEVICES, SIGNS, BARRICADES, ETC. BEING USED ON THE PROJECT IN COMPLIANCE WITH THE APPROVED TRAFFIC CONTROL PLAN. THIS DIARY SHALL BE SUBMITTED TO BERNALILLO COUNTY TRAFFIC ENGINEERING UPON COMPLETION OF THE PROJECT CONSTRUCTION OR WHEN SO REQUESTED BY THE PROJECT MANAGER OR BERNALILLO COUNTY TRAFFIC ENGINEERING.
4. CONTRACTOR SHALL PROVIDE A WEEKLY CONSTRUCTION ACTIVITY SCHEDULE TO BERNALILLO COUNTY PUBLIC WORKS DIVISION ATTN: PROJECT MANAGER
5. THE CONTRACTOR SHALL FILE A WEEKLY WRITTEN REPORT TO TRAFFIC ENGINEERING DESCRIBING THE TRAFFIC CONTROL PLAN THAT WILL BE IN EFFECT FOR THE FOLLOWING WEEK.
6. SUBJECT TO THE APPROVED TRAFFIC CONTROL PLAN, AT LEAST ONE LANE SHALL BE OPEN TO TRAFFIC AT ALL TIMES. CONTRACTOR SHALL PROVIDE PROPER SIGNAGE AND FLAGMAN AND SHALL MAINTAIN THE TRAFFIC LANE IN SUCH A MANNER AS TO ASSURE PROPER SAFETY TO THE TRAVELING PUBLIC AT ALL TIMES. IN CASES WHEN GRADING, EXCAVATION AND BACKFILL OPERATIONS ARE BEING CONDUCTED IMMEDIATELY IN FRONT OF THE PROPERTY, ACCESS WILL NOT BE DENIED FOR MORE THAN 4 HOURS WITHOUT APPROVAL BY THE COUNTY.
7. TRAFFIC LANES PROVIDED DURING CONSTRUCTION SHALL BE MAINTAINED, IN SUCH A CONDITION UNDER ALL WEATHER CONDITIONS, SO AS TO PERMIT THE REASONABLE PASSAGE OF MOTOR VEHICLES, AND SHALL BE KEPT GRADED AND SMOOTH, AND WATERED SEVERAL TIMES DAILY TO CONTROL DUST.
8. TYPICAL TRAFFIC CONTROL PLANS DO NOT REFLECT THE EXISTING TOPOGRAPHY SUCH AS DRIVEWAYS, LANE WIDTHS, AND BUSINESS/RESIDENTIAL ACCESSES. EVERY LOCATION THAT REQUIRES CONSTRUCTION TRAFFIC CONTROL SHALL HAVE A DETAILED TRAFFIC CONTROL PLAN SHOWING ALL EXISTING TOPOGRAPHY.
9. CONSTRUCTION SHALL NOT BEGIN UNLESS A TRAFFIC CONTROL PLAN HAS BEEN APPROVED AND VERIFIED BY BERNALILLO COUNTY TRAFFIC ENGINEERING.
10. ALL CONSTRUCTION TRAFFIC CONTROL DEVICES SHALL COMPLY WITH THE MANUAL ON UNIFORM TRAFFIC CONTROL DEVICES (MUTCD), LATEST EDITION. IT IS THE RESPONSIBILITY OF THE CONTRACTOR TO INSTALL, SERVICE AND MAINTAIN ALL TRAFFIC CONTROL DEVICES. TRAFFIC CONTROL DEVICES SHALL NOT BE REMOVED OR ALTERED IN ANY WAY WITHOUT THE APPROVAL OF BERNALILLO COUNTY TRAFFIC ENGINEERING, PER THE LATEST EDITION OF THE MUTCD.
11. THE CONSTRUCTION TRAFFIC CONTROL INITIAL SET-UP FOR EACH PHASE SHALL BE BY AN AMERICAN TRAFFIC SAFETY SERVICES ASSOCIATION (ATSSA) CERTIFIED WORKSITE TRAFFIC SUPERVISOR. THE MAINTENANCE AND SERVICING SHALL ALSO BE DONE BY AN ATSSA CERTIFIED WORKSITE TRAFFIC SUPERVISOR OR EQUIVALENT.
12. CONTRACTOR IS RESPONSIBLE TO MAINTAIN AND SERVICE ALL TRAFFIC CONTROL DEVICES 24 HOURS A DAY, 7 DAYS A WEEK THROUGHOUT LENGTH OF PROJECT. CONTRACTOR IS RESPONSIBLE THAT ALL TRAFFIC CONTROL DEVICES COMPLY WITH THE MUTCD, LATEST EDITION.
13. ALL ADVANCE WARNING SIGNS SHALL BE DOUBLE INDICATED WHENEVER THERE ARE MULTI-LANE TRAFFIC IN ANY ONE GIVEN DIRECTION AND THERE IS SUFFICIENT MEDIAN SPACE.
14. ALL CHANNELIZATION DEVICES IN ALL TAPERS AND TANGENTS SHALL BE PLACED APART, A DISTANCE MEASURED IN FEET, EQUAL TO THAT OF THE POSTED SPEED LIMIT. NO EXCEPTIONS UNLESS APPROVED BY BERNALILLO COUNTY TRAFFIC ENGINEERING PER THE LATEST EDITION OF THE MUTCD.
15. EQUIPMENT OR MATERIALS SHALL NOT BE STORED WITHIN 15 FEET OF A TRAVELED TRAFFIC LANE DURING NON-WORKING HOURS WITHOUT THE APPROVAL OF BERNALILLO COUNTY TRAFFIC ENGINEERING.
16. CONTRACTOR SHALL PROVIDE AND MAINTAIN SAFE AND ADEQUATE PEDESTRIAN AND BICYCLE ROUTES AROUND THE CONSTRUCTION AREA.
17. CONTRACTOR IS RESPONSIBLE FOR OBLITERATION OF ANY CONFLICTING STRIPING AND RESPONSIBLE FOR ALL TEMPORARY STRIPING.
18. CONTRACTOR SHALL MAINTAIN ACCESS TO ALL FACILITIES, BUSINESSES AND/OR RESIDENTS AND COORDINATE WITH ALL INVOLVED AS NEEDED.

19. CONTRACTOR SHALL PROVIDE ACCESS SIGNS FOR BUSINESSES LOCATED WITHIN THE CONSTRUCTION AREA UNDER THE SUPERVISION OF BERNALILLO COUNTY TRAFFIC ENGINEERING. EACH ACCESS SIGN SHALL HAVE 5 INCH, WHITE LETTERING ON BLUE BACKGROUND. SHOPPING CENTERS AND MALLS SHALL BE LISTED AS SUCH.

20. 48 HOURS PRIOR TO OCCUPYING OR CLOSING OF A RIGHT-OF-WAY, CONTRACTOR SHALL NOTIFY: POLICE, FIRE DEPARTMENT, SCHOOLS, HOSPITALS, TRANSIT AUTHORITY, BUSINESSES AND/OR RESIDENTS THAT WILL BE AFFECTED BY THE CONSTRUCTION.

21. ANY FIELD ADJUSTMENTS SHALL BE APPROVED BY BERNALILLO COUNTY TRAFFIC ENGINEERING OR BERNALILLO COUNTY PROJECT MANAGER.

22. EXCAVATIONS SHALL BE PLATED, TEMPORARILY PATCHED OR RESURFACED PRIOR TO OPENING OF TRAFFIC. A MINIMUM OF 11 FEET, SHALL BE PROVIDED FOR TRAFFIC IN ANY GIVEN DIRECTION. CONTRACTOR IS RESPONSIBLE FOR ANY WORK INVOLVED IN SATISFYING THESE REQUIREMENTS.

23. THE CONTRACTOR SHALL CONTACT BERNALILLO COUNTY TRAFFIC ENGINEER (848-1575) BEFORE REMOVING AND/OR INSTALLING ANY TRAFFIC SIGNS OR PERMANENT STRIPING AND MARKINGS. ALL STRIPING, PAVEMENT MARKINGS INCLUDING CROSSWALKS, LEGENDS AND SYMBOLS ARE TO BE CONSTRUCTED OF INTERSECTION GRADE HOT/PREFORMED THERMOPLASTIC AND LINE MARKINGS ARE TO BE CONSTRUCTED OF HIGH DURABLE PAINT IN ACCORDANCE WITH THE MANUAL ON UNIFORM TRAFFIC CONTROL DEVICES (MUTCD) LATEST EDITION. ANY PAVEMENT MARKINGS AND SIGNS REMOVED OR DAMAGED DURING CONSTRUCTION SHALL BE REPLACED AT EXISTING LOCATIONS (SUCH WORK SHALL BE CONSIDERED INCIDENTAL TO CONSTRUCTION OF THE PROJECT).

FOR BID ONLY

TAPER REQUIREMENT

SPEED LIMIT (MPH)	TAPER LENGTH(L) (FEET)			MINIMUM NUMBER OF DEVICES FOR TAPER	MAXIMUM DEVICE SPACING IN FEET	
	10' LANE	11' LANE	12' LANE		ALONG TAPER	AFTER TAPER
20	70	75	80	5	20	20
25	105	115	125	6	25	25
30	150	165	180	7	30	30
35	205	225	245	8	35	35
40	270	295	320	9	40	40
45	450	495	540	13	45	45
50	500	550	600	13	50	50
55	550	605	660	13	55	55

RECOMMENDED ADVANCE WARNING SIGN MINIMUM SPACING

ROAD TYPE	DISTANCE BETWEEN SIGNS**		
	A	B	C
URBAN (LOW SPEED)*	100 FT	100 FT	100 FT
URBAN (HIGH SPEED)*	350 FT	350 FT	350 FT
RURAL	500 FT	500 FT	500 FT
EXPRESSWAY/FREEWAY	1,000 FT	1,500 FT	2,640 FT

* LOW SPEED - 40MPH OR LESS, HIGH SPEED - 45MPH OR GREATER

** THE COLUMN HEADINGS A, B, AND C ARE THE DIMENSIONS SHOWN IN FIGURES 6H-1 THROUGH 6H-46 IN THE MUTCD. THE A DIMENSION IS THE DISTANCE FROM THE TRANSITION OR POINT OF RESTRICTION TO THE FIRST SIGN. THE B DIMENSION IS THE DISTANCE BETWEEN THE FIRST AND SECOND SIGNS. THE C DIMENSION IS THE DISTANCE BETWEEN THE SECOND AND THIRD SIGNS. (THE "FIRST SIGN" IS THE SIGN CLOSEST TO THE TTC ZONE. THE "THIRD SIGN" IS THE SIGN THAT IS FURTHEST UPSTREAM FROM THE TTC ZONE.)

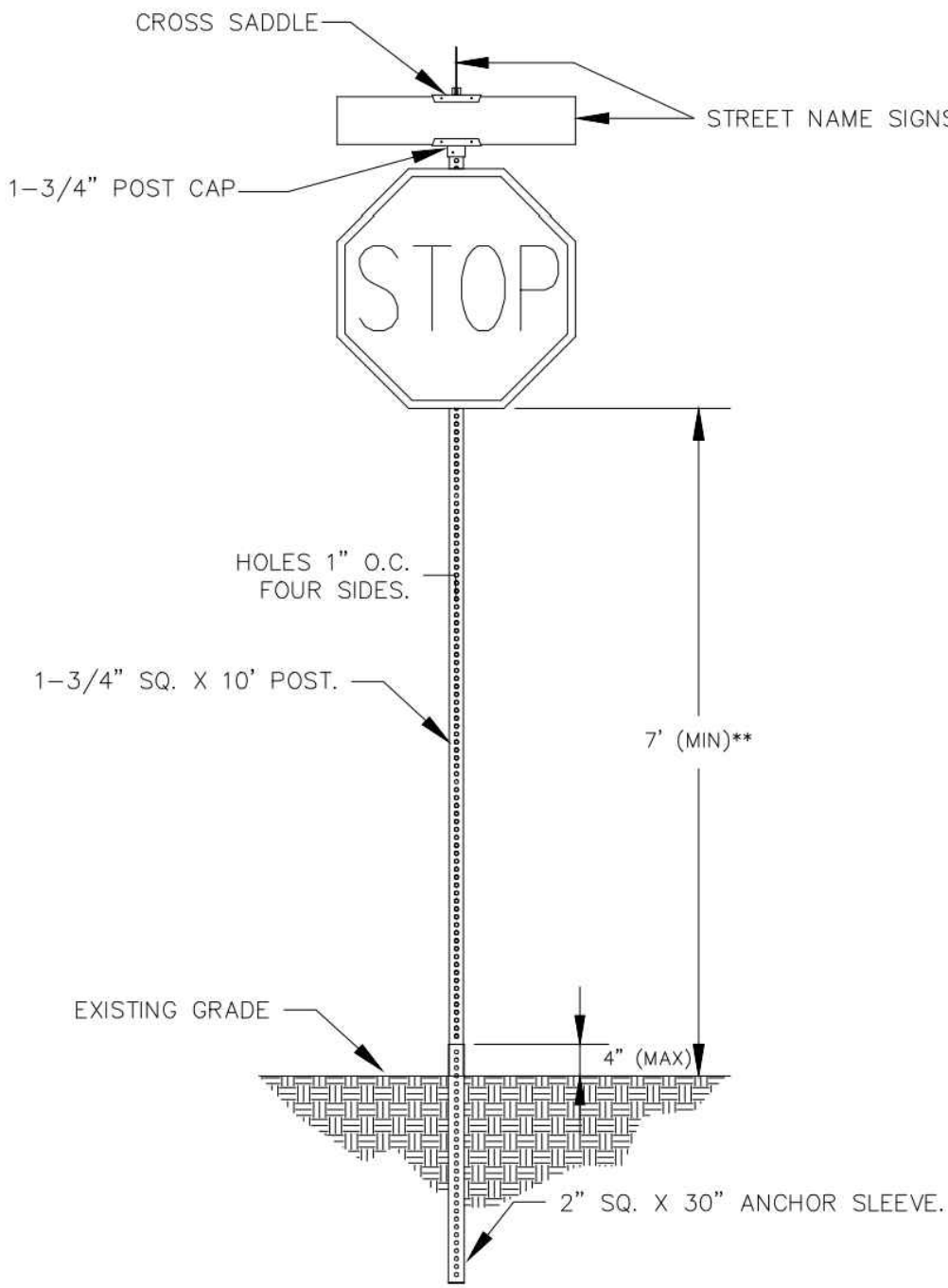

SIGN POST DETAIL SCALE: N.T.S

*ALL STREET NAME SIGN LETTERS SHALL COMPLY WITH THE MOST CURRENT EDITION OF THE MUTCD AND SHALL BE COMPOSED OF A COMBINATION OF LOWER-CASE LETTERS WITH INITIAL UPPER-CASE LETTERS. FOR SPEEDS OF 25 MPH AND BELOW THE INITIAL UPPER-CASE LETTER SHALL BE 4" IN HEIGHT AND LOWER-CASE LETTERS AT LEAST 3" IN HEIGHT. FOR SPEEDS BETWEEN 25 MPH AND 40 MPH THE INITIAL UPPER-CASE LETTER SHALL BE 6" IN HEIGHT AND LOWER-CASE LETTERS AT LEAST 4.5" INCHES IN HEIGHT. FOR SPEEDS GREATER THAN 40 MPH THE INITIAL UPPER-CASE LETTER SHALL BE 8" IN HEIGHT AND LOWER-CASE LETTERS AT LEAST 6" IN HEIGHT.

**SEE MUTCD FOR MINIMUM MOUNTING HEIGHT IN RURAL AREAS

# OF POSTS	MAXIMUM SIGN SQUARE FOOTAGE
1	6
2	12
3	18

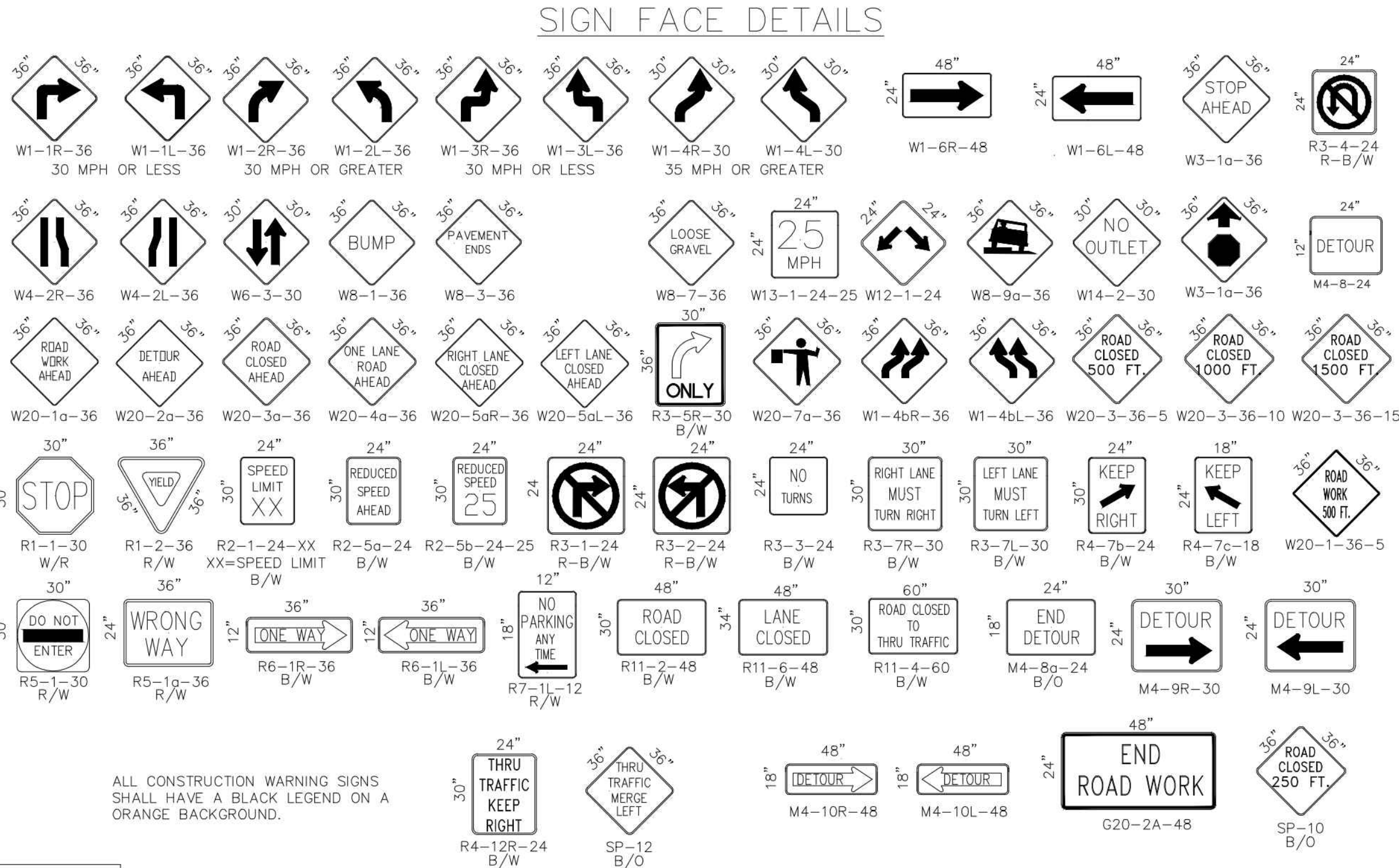

ALL CONSTRUCTION WARNING SIGNS SHALL HAVE A BLACK LEGEND ON A ORANGE BACKGROUND.

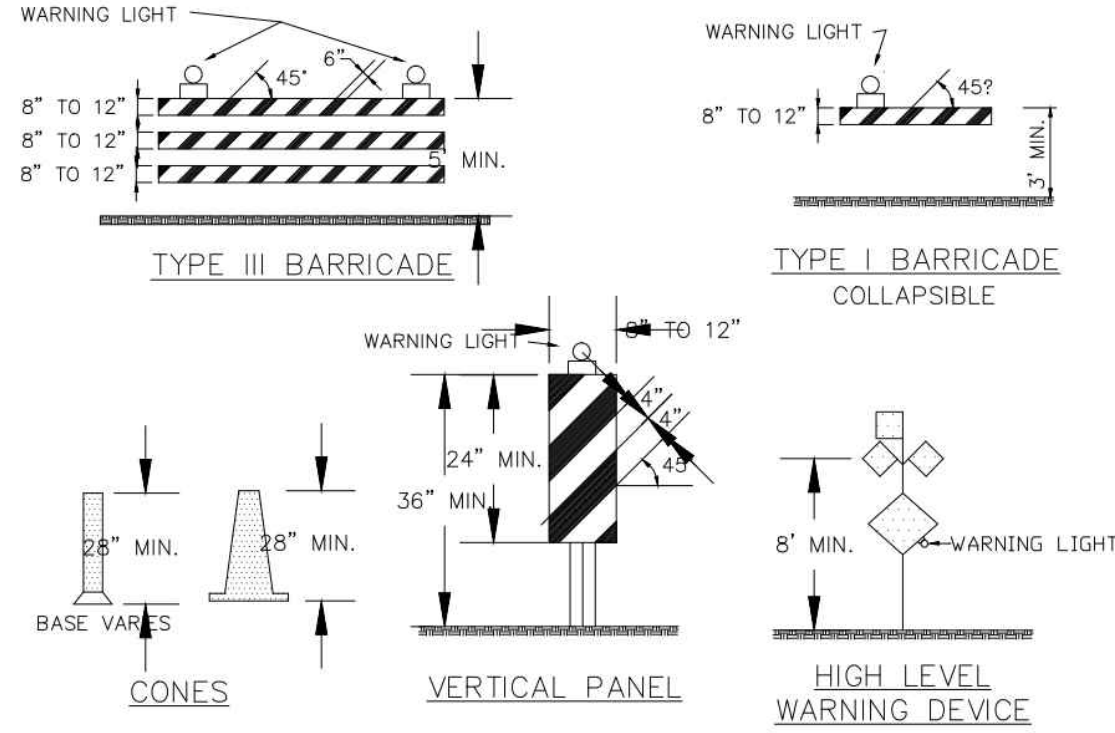

TAPER CRITERIA

TYPE OF TAPER	TAPER LENGTH
UPSTREAM TAPER:	
MERGING TAPER	L MINIMUM
SHIFTING TAPER	1/2 L MINIMUM
SHOULDER TAPER	1/2 L MINIMUM
TWO-WAY TRAFFIC TAPER	100 FEET MAXIMUM
DOWNSTREAM TAPERS	100 FEET PER LANE

TAPER LENGTH COMPUTATION

SPEED LIMIT	
(LOW SPEED) 40 MPH OR LESS	$L = \frac{WS^2}{60}$
(HIGH SPEED) 45 MPH OR GREATER	$L = W \times S$

L = TAPER LENGTH
W = WIDTH OF OFFSET IN FEET
S = POSTED SPEED OR OFF-PEAK 85-PERCENTILE SPEED IN MPH

STOPPING SIGHT DISTANCE (L) AS A FUNCTION OF SPEED	
SPEED*	DISTANCE (L)
20 MPH	115 FT
25 MPH	155 FT
30 MPH	200 FT
35 MPH	250 FT
40 MPH	305 FT
45 MPH	360 FT
50 MPH	425 FT
55 MPH	485 FT
60 MPH	570 FT
65 MPH	645 FT
70 MPH	730 FT
75 MPH	820 FT

* POSTED SPEED, OFF-PEAK 85TH PERCENTILE SPEED PRIOR TO WORK STARTING, OR THE ANTICIPATED OPERATING SPEED

TRAFFIC CONTROL ELEMENTS

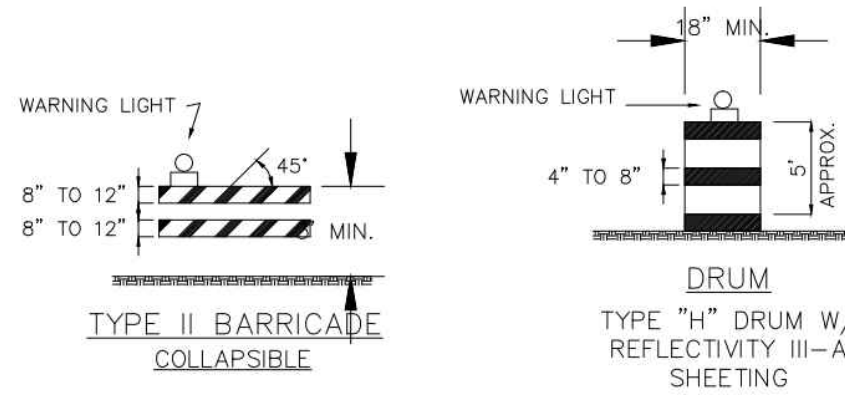

	BY	
NO.	DESCRIPTION	DATE
REVISIONS		
COUNTY OF BERNALILLO		
CIRCLE K		
SIGNING & CONSTRUCTION		
TRAFFIC CONTROL STANDARDS		
X		
PROJECT NO.	DRAWN: XXX	DATE: XX-XX-XX
39075	CHECKED: XXX	SCALE: