

FLOOR PLAN LEGEND

21. LOCATION OF ELECTRICAL PANELS. SEE ELECTRICAL DRAWINGS FOR SPECIFIC INFORMATION.
22. LOCATION OF SES, SEE ELECTRICAL DRAWINGS FOR SPECIFIC INFORMATION.
23. BREAK METAL TO CLOSE GAP BETWEEN WALL AND WALK IN COOLER FROM FLOOR TO CEILING.
SEE DETAIL D3/A12.0.
24. SIGN SHALL BE POSTED AT CASHIER COUNTER THAT READS "COMPLIMENTARY WATER CUPS AVAILABLE ON REQUEST"
25. LINE OF CANOPY / SOFFIT ABOVE, SEE REFLECTED CEILING PLAN SHEET A-4.0 AND EXT. ELEVATIONS SHEETS A6.0 AND A6.1.
26. KNOX BOX LOCATION, SEE RECESS DETAIL B5/A12.1.
27. PROVIDE SIGN ABOVE HAND SINK "EMPLOYEE MUST WASH HANDS BEFORE RETURNING TO WORK".
28. UNDERGROUND GREASE INTERCEPTOR, SEE PLUMBING AND CIVIL DRAWINGS.
29. 34" HIGH ACCESSIBLE COUNTERTOP.
30. RECESSED FUEL EMERGENCY SHUT-OFF SWITCH WITH COVER, MOUNTED AT 40" A.F.F. ON EXTERIOR PLAN, SEE FUEL PLAN.
31. EMERGENCY PUMP-SHUT-OFF SWITCH MOUNTED ON TOP OF COUNTER. COORDINATE FINAL LOCATION WITH CIRCLE K REP.
32. 1 1/2" STAINLESS STEEL CORNER GUARDS. SEE EQUIPMENT PLAN AND SCHEDULE, SHEET A7.0 & A7.1.
33. 6" CONC. CURB AT ELECTRICAL FLOOR PENETRATIONS.
34. CO2 TANK
35. RECESSED CO2 REMOTE FILL BOX MOUNTED AT 40" A.F.F. ON EXTERIOR WALL.
36. HOSE BIB, SEE PLUMBING DRAWINGS.

1. DIMENSIONS SHOWN ARE TO FACE OF PLYWOOD, UNLESS OTHERWISE NOTED. WALL DIMENSION DESCRIPTIONS:
 - A) EXTERIOR WALL: (EXTERIOR FACE OF PLYWOOD + WALL THICKNESS + INTERIOR CYP. BD.)
 - B) INTERIOR WALL: (CYP. BD. + WALL THICKNESS + CYP. BD.)
 - C) TOLERANCE ON EXTERIOR AND INTERIOR WALLS = $\pm 1/4"$
2. SEE SHEETS A7.0 & A7.1 FOR EQUIPMENT SCHEDULE AND EQUIPMENT FLOOR PLAN, RESPECTIVELY.
3. COORDINATE ALL DIMENSIONS IN AREAS OF WALK-IN COOLERS WITH EQUIPMENT INSTALLERS
4. A) INSTALL FULL THICKNESS BATT INSULATION CONTINUOUS TO ROOF DECK IN ALL WALLS SEPARATING RESTROOMS FROM ADJACENT CONVENIENCE STORE AREAS. INSULATION TO BE NON-COMBUSTIBLE AND BEARING THE UL CLASSIFICATION MARKING
4. B) ALL INSULATION SHALL NOT BE EXPOSED TO VIEW FROM INSIDE SALES FLOOR AREA
5. BRACE STUDS ABOVE CEILING AS REQUIRED TO PROVIDE RIGID WALLS THROUGHOUT, SEE STRUCTURAL DRAWINGS
6. ALL CABINETS SHOWN ARE OF WOOD CONSTRUCTION, W/REMOVABLE ACCESS TO FLOOR SINKS MOUNTED ON 6" HIGH METAL LEGS. CABINETS, COFFEE BAR, AND MAGAZINE RACK SUPPLIED AND INSTALLED BY SUPPLIER
7. A) USE FDA APPROVED FOOD GRADE CLEAR CAULKING BETWEEN COUNTERTOPS AND WALLS AND WHERE REQUIRED PER LOCAL AND COUNTY HEALTH DEPARTMENT REQUIREMENTS
7. B) SEAL TO BE PLACIBLE SEAL PERIMETER OF WALL OPENINGS AND JOINTS WHERE MOVEMENT OF SURFACES WILL ADMIT AIR OR WATER INTO BUILDING, SEAL ALL CONDENSATE PENETRATIONS INTO BUILDING
8. GENERAL CONTRACTOR SHALL COORDINATE WITH THE EQUIPMENT AND DRYWALL INSTALLERS TO ENSURE THAT ALL ELECTRICAL WIRING, WATER LINES AND REFRIGERATION LINES HAVE BEEN INSTALLED PROPERLY ON ALL EQUIPMENT PRIOR TO THE HANGING OF ANY DRYWALL. SEE THE CIRCLE K PROJECT MANAGER FOR ANY EQUIPMENT LOCATION CLARIFICATIONS.
9. PROVIDE 5/8" MOISTURE-RESISTANT GYPSUM WALLBOARD THROUGHOUT WHERE REQUIRED.
10. ALL WOOD FRAMING MEMBERS IN CONTACT WITH CONCRETE OR GCM SHALL BE PRESSURE TREATED DOUGLAS FIR U.O.N TYPE.
11. IT SHALL BE THE RESPONSIBILITY OF THE CONTRACTOR TO PROVIDE AND INSTALL ALL WOOD BLOCKING, FURRING STRIPS, OR GROUND DETAILS OR REQUIRED TO PROVIDE ANCHORAGE FOR ALL FINISHES, ACCESSORIES, FIXTURES, EQUIPMENT TO BE COMPLETE. ALL WORK, ALL BLOCKING AND/OR BACKING SHALL BE SECURELY BOLTED OR OTHERWISE ANCHORED IN PLACE.

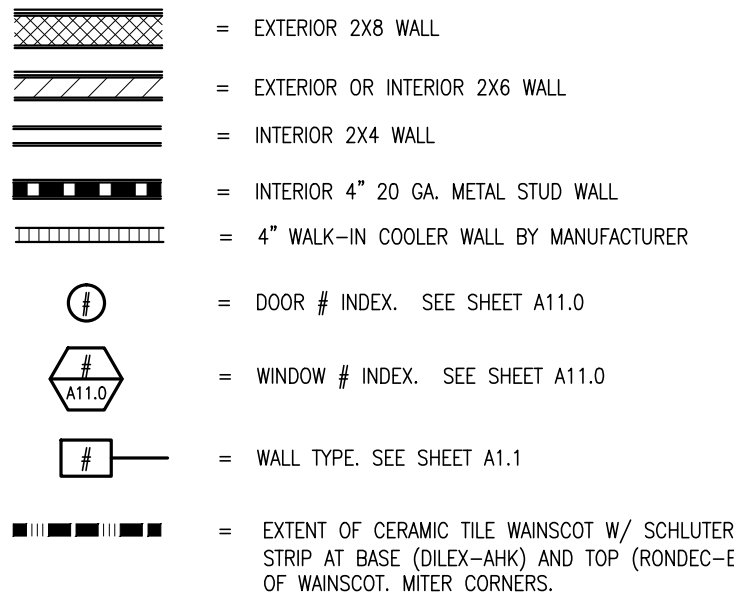

FOR BID ONLY

